

FCR7F-1 SERIES

Tank top return filters

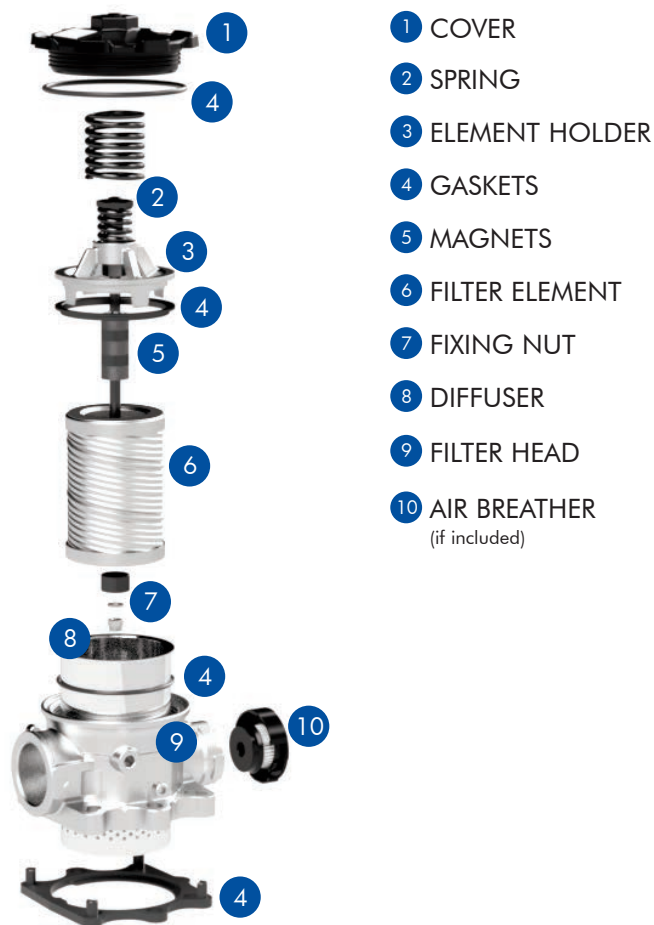

USER TIPS



SPARE SEALS KIT (4)

	NBR	FKM (on request)
FCR7F1-X-XX-X-2A	06.021.00341	06.021.00346
FCR7F1-X-XX-X-4A	06.021.00342	06.021.00347
FCR7F1-X-XX-0-6A	06.021.00343	06.021.00348
FCR7F1-X-XX-1-6A	06.021.00344	06.021.00349
FCR7F1-X-XX-1-6B	06.021.00345	06.021.00350

INDICATOR TIGHTENING TORQUE

10 Nm

COVER TIGHTENING TORQUE (1)

20 Nm

WARNING

- Make sure that Personal Protective Equipment (PPE) is worn during installation and maintenance operation.

DISPOSAL OF FILTER ELEMENT

- The used filter elements and the filter parts dirty of oil are classified as "Dangerous waste material": they must be disposed according to the local laws by authorized Companies.

INSTALLATION

1. Make sure that all the filter components are properly mounted as per exploded view directions.
2. Enough space must be available for filter element replacement.
3. Keep in stock a spare FILTREC filter element for timely replacement when required.
4. Filter housing should be earthed.

OPERATION

1. The filter must work within the operating conditions of pressure, temperature and compatibility given in the first page of this data sheet.
2. The filter element must be replaced as soon as the clogging indicator signals at working temperature.
3. If no clogging indicator is mounted, replace the element according to the system manufacturer's recommendations.

MAINTENANCE

1. Before removing the access cover (1), ensure that the system is switched off and there is no residual pressure in the filter.
2. Remove the access cover (1).
3. Remove the spring (2) and extract the filter element assembly.
4. Warning: a certain quantity of oil can be retained within the filter element, provide to have a proper container available for it.
5. Unscrew the nut at the bottom of the insert and slip the dirty filter element carefully.
6. Clean the tie rod (and the magnets if present) and check the support gaskets/o-ring (4) conditions, replace them if necessary.
7. Fit a new FILTREC element, the spacer and the washer over the tie rod, then screw on it the fixing nut. To achieve the optimal element fitting, tighten the nut until it gets in touch with the washer and the element is stuck; then screw in the nut for one more turn.
8. Put the insert assembly into its seat within the tank, put the spring (2) in its position over the element holder(3), then mount the access cover (1) and secure it properly.
9. The used filter elements cannot be cleaned and re-used.