

FBM SERIES

Air filters and filler breathers, with replaceable filter element

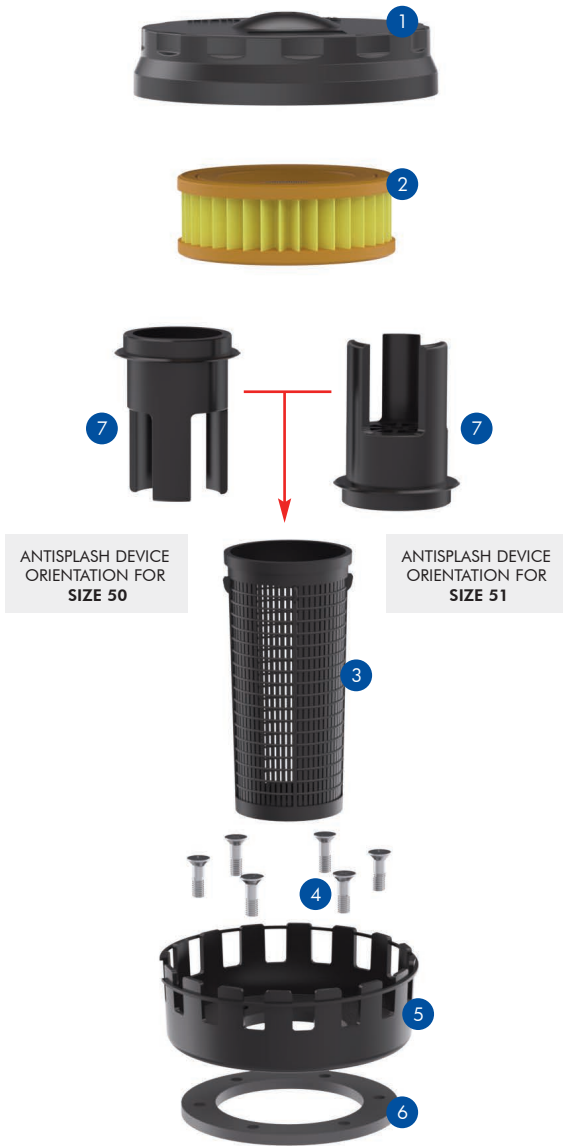

USER TIPS



- 1 COVER
- 2 FILTER ELEMENT
- 3 BASKET
- 4 SCREWS
- 5 LOWER BODY
- 6 GASKET
- 7 ANTISPLASH

WARNING

⚠ Make sure that Personal Protective Equipment (PPE) is worn during installation and maintenance operation.

DISPOSAL OF FILTER ELEMENT

⚠ The used filter elements and the filter parts dirty of oil are classified as "Dangerous waste material": they must be disposed according to the local laws by authorized Companies.

INSTALLATION

1. Unscrew the cover (1).
2. Remove the filter element (2).
3. Insert the basket (3) in the lower body (5).
4. Place the gasket (6) on the tank; pay attention to keep the holes aligned.
5. Place the lower body (5) with the basket (3) on the gasket (6); pay attention to keep the holes aligned.
6. Attach the lower body (5) on the tank with the six screws. Screw until contact between screws and housing, then tighten for 2 more turns.
7. Fill the tank up to the set level.
8. Clean the lower body (5) from oil waste.
9. If the antisplash device (7) is provided, fit it in the basket (3). Antisplash orientation depends from the size (see image).
10. Fit the filter element (2) in the lower body (5).
11. Tighten the cover (1) on the lower body (5) applying 1/4 turn after the contact between the filter element (2) and the cover (1).

MAINTENANCE

- ⚠** 1. Before removing the cover (1) from the lower body (5), ensure that the system is switched off and there is no residual pressure in the filter.
2. Unscrew the cover (1).
3. Clean the lower body (5) from oil waste.
4. Fit the new filter element (2) in the lower body (5).
5. Tighten the cover (1) on the lower body (5) applying 1/4 turn after the contact between the filter element (2) and the cover (1).