

USER TIPS

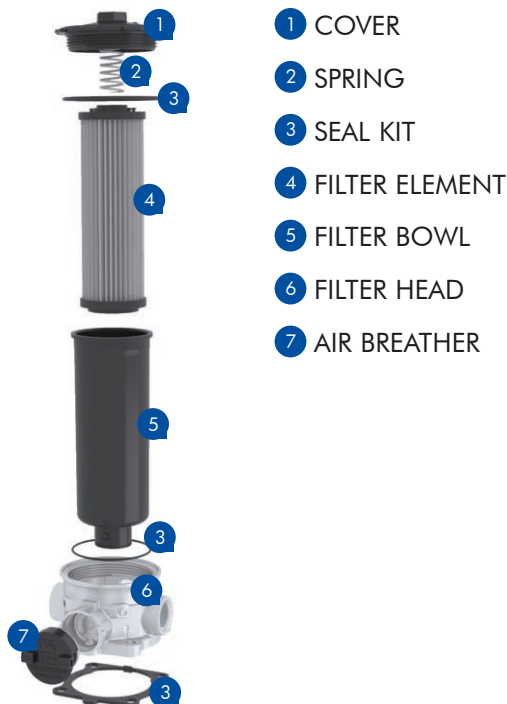

SPARE SEALS KIT (3)

	NBR
FR6-2-R1-0x	06.021.00256
FR6-4-R1-0x	06.021.00257
FR6-2-R1-2x/3x	06.021.00258
FR6-4-R1-2x/3x	06.021.00259
FR6-6-R1-2x/3x	06.021.00260

COVER TIGHTENING TORQUE

20 Nm

INDICATOR TIGHTENING TORQUE

10 Nm

WARNING



Make sure that Personal Protective Equipment (PPE) is worn during installation and maintenance operation.

DISPOSAL OF FILTER ELEMENT



The used filter elements and the filter parts dirty of oil are classified as "Dangerous waste material": they must be disposed according to the local laws by authorized Companies.

INSTALLATION

1. The gasket (7) must be properly positioned and the head (6) well secured on the tank lid through the fixing holes.
2. The hose must be properly connected to the IN port.
3. The OUT port must be clear (an extension tube could be fitted, if needed for having the outlet below the oil level).
4. Verify that no tension is present on the filter after mounting.
5. When present the air breather (8), it must be in a protected position.
6. Enough space must be available for filter element replacement.
7. The visual clogging indicator must be in a easily viewable position.
8. When a electrical indicator is used, make sure that it is properly wired.
9. Keep in stock a spare FILTREC filter element for timely replacement when required.

OPERATION



1. The filter must work within the operating conditions of pressure, temperature and compatibility given in the first page of this data sheet.
2. The filter element must be replaced as soon as the clogging indicator signals at working temperature (in cold start conditions, oil temperature lower than 30°C, a false alarm can be given due to oil viscosity).
3. If no clogging indicator is mounted, replace the element according to the system manufacturer's recommendations.

MAINTENANCE



1. Before removing the cover (1), ensure that the system is switched off and there is no residual pressure in the filter.
2. Unscrew the cover (1) by turning it anti-clockwise and remove it.
3. Remove the spring (2) first, then the dirty element (4) and the bowl (5).
4. Clean the bowl (5) and fit a new FILTREC element (4), verifying the part number, particularly concerning the micron rating.
5. When fitting the new element (4), open its plastic protection on the open end side and insert it onto the spigot in the filter bowl, then remove completely the plastic protection.
6. Check the O-ring (3) conditions and replace if necessary.
7. Put the spring (2) in its position on the filter element.
8. Screw the cover (1) by turning it clockwise, tighten at the recommended torque.
9. The used filter elements cannot be cleaned and re-used.