

## USER TIPS

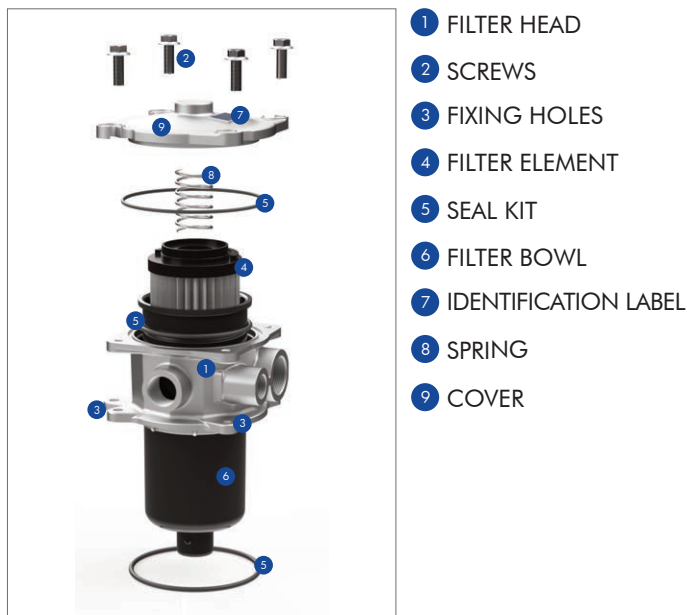

### SPARE SEALS KIT (5)

|              | NBR          | FKM          |
|--------------|--------------|--------------|
| FRM 40 43 45 | 06.021.00282 | 06.021.00283 |

### COVER SCREWS TIGHTENING TORQUE

|     |       |
|-----|-------|
| M10 | 30 Nm |
|-----|-------|

### INDICATOR TIGHTENING TORQUE

|       |
|-------|
| 10 Nm |
|-------|

## WARNING

- ⚠ Make sure that Personal Protective Equipment (PPE) is worn during installation and maintenance operation.

## DISPOSAL OF FILTER ELEMENT

- ⚠ The used filter elements and the filter parts dirty of oil are classified as "Dangerous waste material": they must be disposed according to the local laws by authorized Companies.

## INSTALLATION

1. The filter head (1) must be properly positioned and well secured on the tank lid through the fixing holes.
2. The hose must be properly connected to the IN port.
- ⚠ 3. The OUT port must be clear (an extension tube could be fitted, if needed for having the outlet below the oil level).
4. Verify that no tension is present on the filter after mounting.
5. Enough space must be available for filter element replacement.
6. The visual clogging indicator must be in a easily viewable position.
7. When a electrical indicator is used, make sure that it is properly wired.
8. Keep in stock a spare FILTREC filter element for timely replacement when required.
9. Filter housing should be earthed.

## OPERATION

- ⚠ 1. The filter must work within the operating conditions of pressure, temperature and compatibility given in the first page of this data sheet.
2. The filter element must be replaced as soon as the clogging indicator signals at working temperature.
3. If no clogging indicator is mounted, replace the element according to the system manufacturer's recommendations.

## MAINTENANCE

- ⚠ 1. Before removing the top cover from the head, ensure that the system is switched off and there is no residual pressure in the filter.
2. Loosen the cover fixing bolts and rotate for element removal.
3. Remove the spring (8) first, then the dirty element (4) and the bowl (6).
4. Clean the bowl (6) and fit a new FILTREC element (4), verifying the part number, particularly concerning the micron rating.
5. When fitting the new element (4), open its plastic protection on the open end side and insert it onto the spigot in the filter bowl, then remove completely the plastic protection.
6. Check the top cover O-ring conditions and replace if necessary.
7. Put the spring (8) in its position on the filter element (4).
8. Mount the top cover onto the head and fix it screwing the fixing bolts.
- ⚠ 9. The used filter elements cannot be cleaned and re-used.