

FS5 SERIES

Side wall mounting suction filters

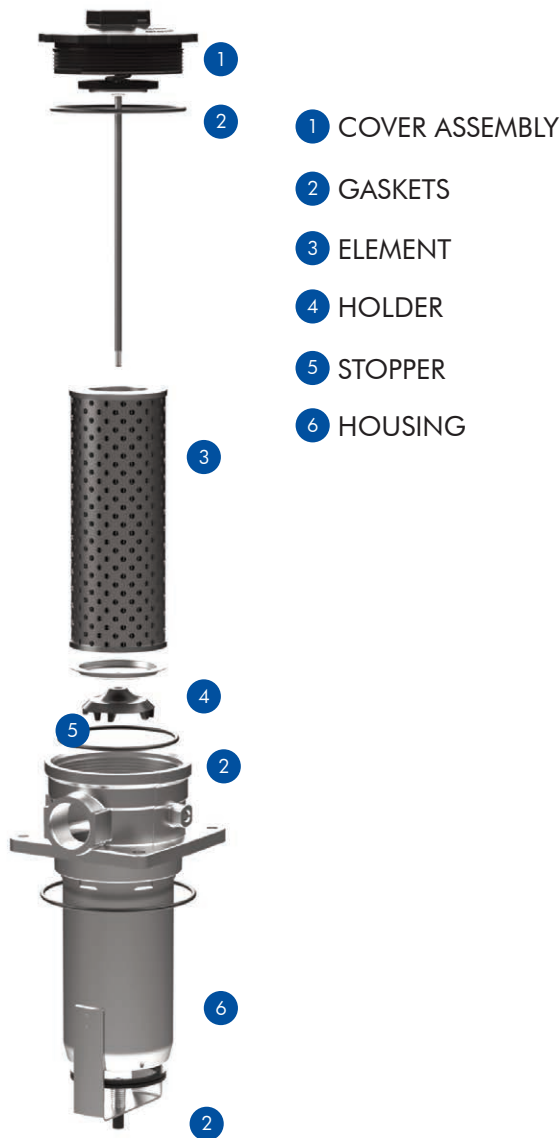

USER TIPS



WARNING

- ⚠ Make sure that Personal Protective Equipment (PPE) is worn during installation and maintenance operation.

DISPOSAL OF FILTER ELEMENT

- ⚠ The used filter elements and the filter parts dirty of oil are classified as "Dangerous waste material": they must be disposed according to the local laws by authorized Companies.

INSTALLATION

- ⚠ 1. The filter housing (6) must be properly positioned and well secured on the tank side wall through the fixing holes.
- ⚠ 2. The OUT port must be properly connected to the suction line.
- 3. Verify that no tension is present on the filter after mounting.
- 4. Enough space must be available for filter element replacement.
- 5. The visual clogging indicator must be in a easily viewable position.
- 6. When a electrical indicator is used, make sure that it is properly wired.
- 7. Keep in stock a spare FILTREC filter element for timely replacement when required.
- 8. Filter housing should be earthed.

OPERATION

- ⚠ 1. The filter must work within the operating conditions of pressure, temperature and compatibility given in the first page of this data sheet.
- 2. The filter element must be replaced as soon as the clogging indicator signals at working temperature.
- 3. If no clogging indicator is mounted, replace the element according to the system manufacturer's recommendations.

MAINTENANCE

- ⚠ 1. Before removing the top cover (1) from the housing (6), ensure that the system is switched off and there is no residual pressure in the filter.
- ⚠ 2. Unscrew the cover (1) by turning it anticlockwise.
- 3. Remove the dirty element (3) by pulling it carefully.
- 4. Fit a new FILTREC element (3), verifying the part number, particularly concerning the micron rating.
- 5. Check the seals (2) conditions and replace if necessary.
- 6. Lubricate the threads and screw completely the cover (1) in the filter housing by turning it clockwise.
- 7. The used filter elements cannot be cleaned and re-used.

SPARE SEAL KIT (2)

NBR	06.021.00420
-----	--------------

INDICATOR TIGHTENING TORQUE

10 Nm

COVER TIGHTENING TORQUE

20 Nm